

ACO CABLEMATE®	POLYCRETE® PIT INSTALLATION DRAWING	
DRWG# XCPR-BG-3	With Rhinocast® Recessed / Solid Top Cover	
Grass: For 2670kg Nominal Wheel Load		

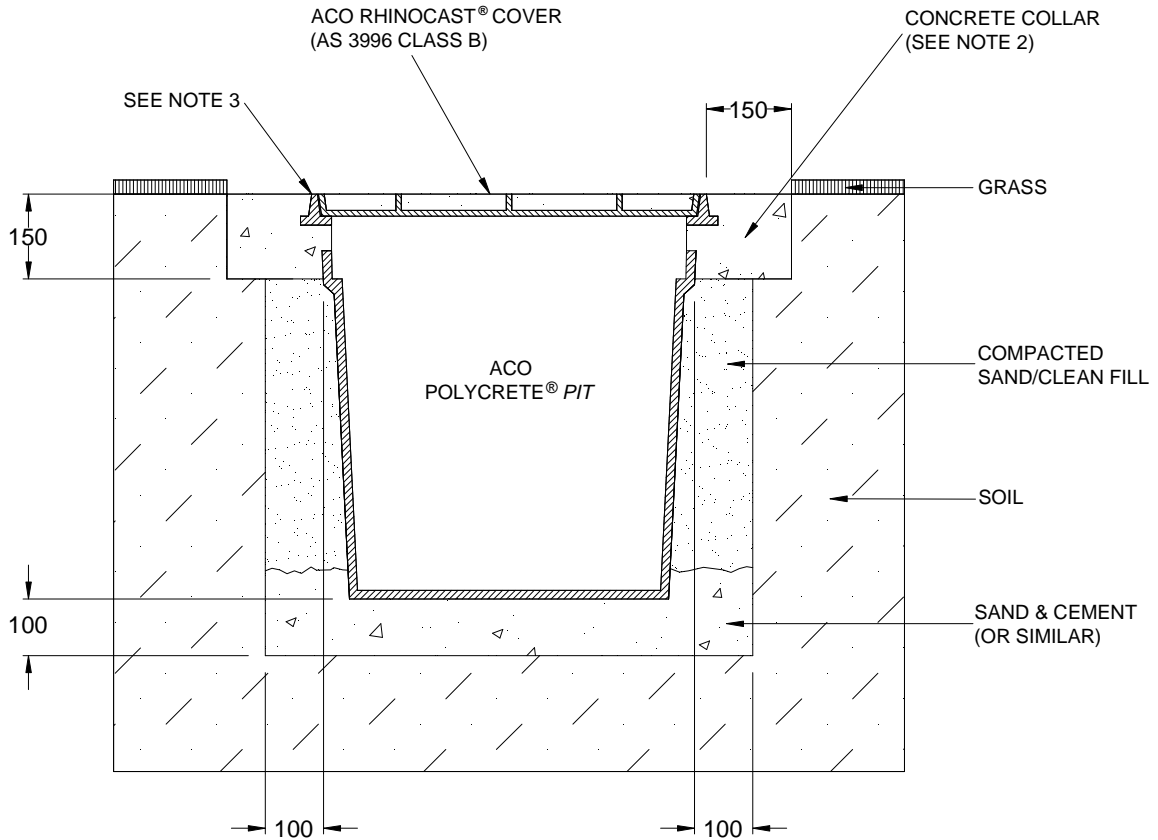

NOTES:

1. Specific site conditions may require an increase in these dimensions or reinforcement. It is the customer's responsibility to ensure the installation drawing is detailed for the application and pit structure is protected from undue stress. *Engineering advice may be required.*
2. A minimum concrete strength of 25MPa is recommended for the collar. The concrete should be vibrated to eliminate air pockets.
3. The finished level of the concrete collar must be flush with the top of the frame.
4. Refer to ACO's latest installation instructions for complete details.

ACO CABLEMATE®	POLYCRETE® PIT SPECIFICATION CLAUSE	ACO Polycrete Pty Ltd Australia Ph: 1300 765 226 www.acoaus.com.au
DRWG# XCPR-BG-3	With Rhinocast® Recessed / Solid Top Cover	ACO Limited New Zealand Ph: 0800 448 080 www.aconz.co.nz

The cable enclosure(s) (for a nominal wheel load of 2670kg) with a *clear opening(s)* of shall be **Polycrete® Pit(s) Type (s)** and *part no.(s)* with **Rhinocast® Recessed / Solid Top cover(s)** and *part no.(s)*

All materials and components within the scope of the system shall be obtained from ACO and the work shall be carried out as specified in accordance with the manufacturer installation recommendations.