

'P' Trap

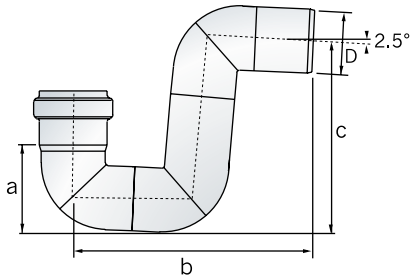

External Ø D (mm)	Dim. a (mm)	Dim b (mm)	Dim c (mm)	Weight (kg)	Grade 304 Part No	Grade 316 Part No
'P' Trap						
50	68	187	149	0.5	98822	98872
75	94	232	193	0.7	98824	98874
110	132	300	254	1.3	98826	98876
160	190	404	347	3.3	98828	98878

Bulkhead Penetration Pipe

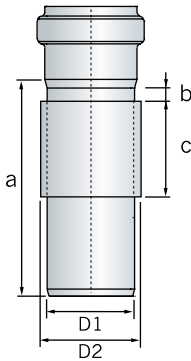

Ø D1/D2	a	b	c	Weight	304	316
Bulkhead Penetration Pipe						
50/60	150	33	50	0.5	n/a	98990
50/60	250	33	100	1.0	n/a	98998
50/60	500	33	100	1.3	n/a	98980
75/89	150	24	50	0.8	n/a	98982
75/89	250	24	100	1.5	n/a	98950
75/89	500	24	100	2.0	n/a	98984
110/125	150	18	50	1.0	n/a	98986
110/125	250	18	100	2.1	n/a	98952
110/125	500	18	100	2.5	n/a	98988
160/168	250	10	100	3.2	n/a	98954

Bulkhead penetration pipes are used where the welding of stainless pipe to bulkheads, decks and steel flooring is required.

Access Unit

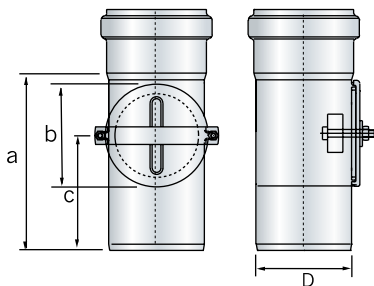

Ø D	a	b	c	Weight	304	316
Access Unit						
50	-	-	-	-	n/a	n/a
75	139	70	90	0.5	98913	98963
110	183	105	117	0.8	98915	98965
160	288	155	184	2.3	98917	98967

Vent Cowl

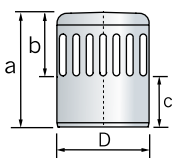

Ø D	a	b	c	Weight	304	316
Vent Cowl						
110	137	80	57	0.4	n/a	98962

Notes:

EPDM seals supplied as standard - Viton seal available to order - contact ACO for details.

Sockets & Couplings

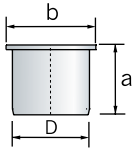

External $\varnothing D$ (mm)	Dim. a (mm)	Dim b (mm)	Weight (kg)	Grade 304 Part No	Grade 316 Part No
Socket Plug					
50	45	58	0.1	n/a	98888
75	45	85	0.3	n/a	98889
110	45	120	0.5	n/a	98890
160	47	170	0.5	n/a	98891

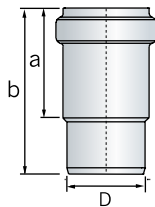

$\varnothing D$	a	b	Weight	304	316
Expansion Socket					
50	102	159	0.2	98664	98666
75	113	175	0.3	98668	98670
110	121	200	0.5	98672	98674
160	170	292	1.4	98676	98678

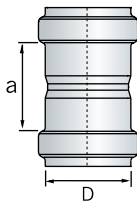

$\varnothing D$	a	b	Weight	304	316
Straight Coupling					
50	54	-	0.1	98920	98970
75	75	-	0.2	98922	98972
110	84	-	0.4	98924	98974
160	110	-	0.8	98926	98976

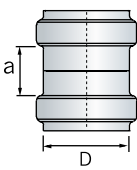

$\varnothing D$	a	b	Weight	304	316
Repair Coupling					
50	30	-	0.1	98830	98880
75	46	-	0.2	98832	98882
110	52	-	0.3	98834	98884
160	76	-	0.7	98836	98886

Repair Couplings are used to aid a convenient repair to a damaged in-situ pipe. Unlike the standard Straight Coupling, there is no central registration to limit the insertion depth of the pipe. The Repair Coupling slides completely over a pipe joint and simply repositioned to bridge the required pipe joint.

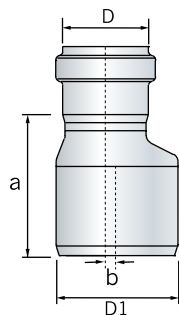

$\varnothing D/D1$	a	b	Weight	304	316
Eccentric Increasing Coupling					
50/75	88	7	1.0	n/a	98892
50/110	103	25	1.1	n/a	98978
75/110	116	15	1.2	n/a	98894
110/160	123	22	1.4	n/a	98896

Notes:

EPDM seals supplied as standard - Viton seal available to order - contact ACO for details.